

A590

M6 junction 36 to Brettargh Holt improvements

September to December 2020



In autumn 2020, we will deliver a number of maintenance and improvement schemes on the A590, between M6 junction 36 and Brettargh Holt roundabout. Together they will ensure safer, more reliable journeys for years to come.

The major part of the work will see the reconstruction of the carriageway along this stretch. We'll be removing the top 32cm (12.5 inches) of road surface before laying down a new one.

We'll also be:

- resurfacing the roundabout at M6 junction 36
- replacing drainage facilities
- replacing the bridge joints
- widening the A590 entry slip at Brettargh Holt roundabout
- improving road markings
- replacing sections of safety barrier on the A590

What we've done so far

Preparation work is currently taking place on the A6 at Borwick roundabout. We're planning further work at A591 Shenstone roundabout. This includes creating breaks in the central barrier, allowing us to set up contraflow systems, ensuring the diversion routes are suitable for all traffic when full closures are needed. Dates for our planned closures are shown on the plans overleaf.

[Visit our webpage](#)



Traffic management

M6 junction 36 roundabout – 24 hour closure of southern section

From 14 September to 10 October, the southern section of the M6 junction 36 roundabout will be closed. This will allow us to repair the bridge joints at this location. Also, the closure will ensure traffic flows smoothly from the M6 junction 36 northbound exit slip onto the A590 westbound carriageway. This will stop traffic building up on the M6 carriageway. Diversion routes will be in place throughout.

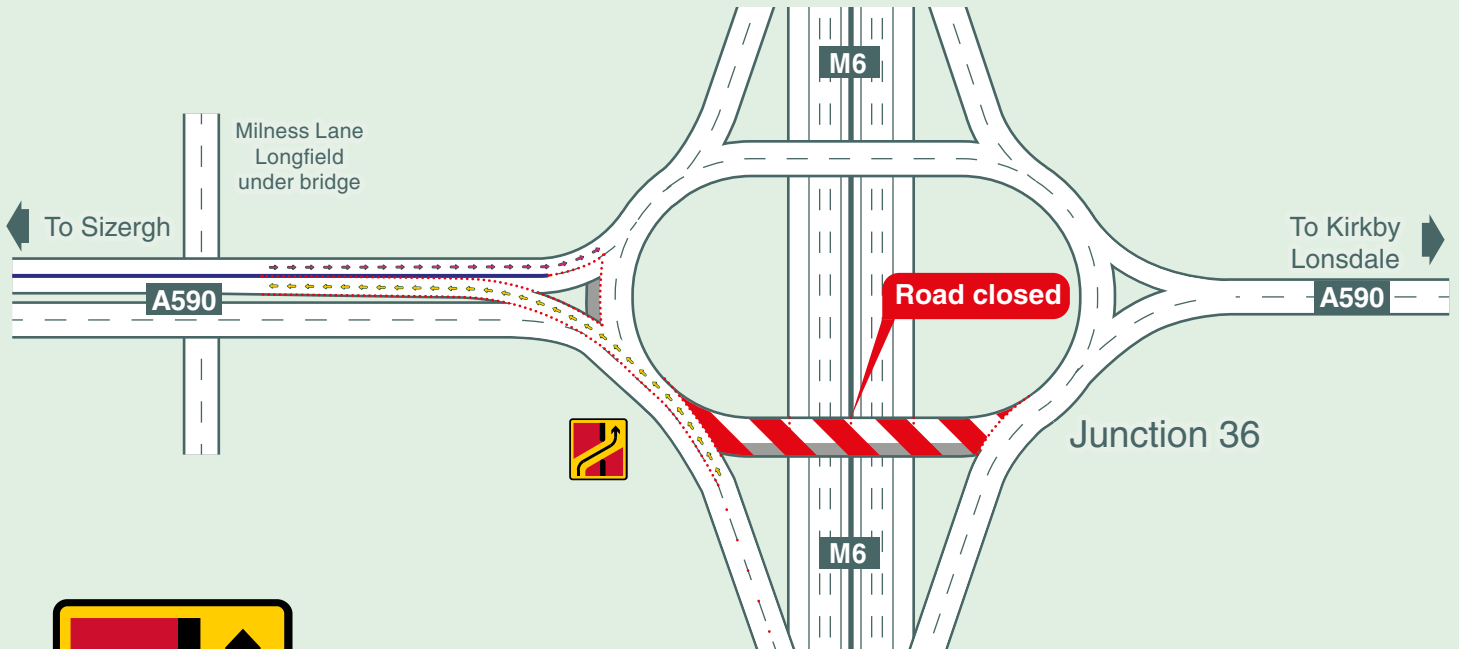

What is a contraflow?

A contraflow system is where a lane of traffic is running in the opposite direction to the other lanes on that carriageway. Drivers will see a temporary barrier between them and oncoming traffic. A reduced speed limit will be in place to ensure motorists travel through the contraflow safely. Two lanes will continue to run in both directions.

A contraflow will be in place on the A590 eastbound between Brettargh Holt roundabout and M6 junction 36 from 14 September to 7 October. This will then switch over to the westbound from 10 to 24 October.

Innovative ways of working

Approximately 60,000 tonnes of asphalt material is needed for this scheme, 43,000 tonnes of which will be recycled. This will be made at our onsite production facility. By recycling the old carriageway into new asphalt, we will:

- reduce carbon emissions by 45%
- significantly reduce the number of haulage deliveries
- work up to 24-hours a day, completing our work as quickly as possible
- reduce overall disruption for our customers and the local community

Closure dates

Closure of **junction 36 roundabout** and **A590 eastbound** between Brettargh Holt to M6 junction 36

- 4 to 13 September
- 25 October to 3 November

Closure of **A590 westbound** between Brettargh Holt to M6 junction 36

- 4 to 6 September
- 11 to 13 September
- 25 October to 3 November

Note: further closures are needed here towards the end of the work. Updates will be available on our webpage.

Planned closures

To ensure that we can set up our work areas to make all these improvements, we'll need to install some traffic management, such as contraflows or full road closures. The plans below show the location of our planned overnight closures, their respective diversion routes and the dates they will be in place.

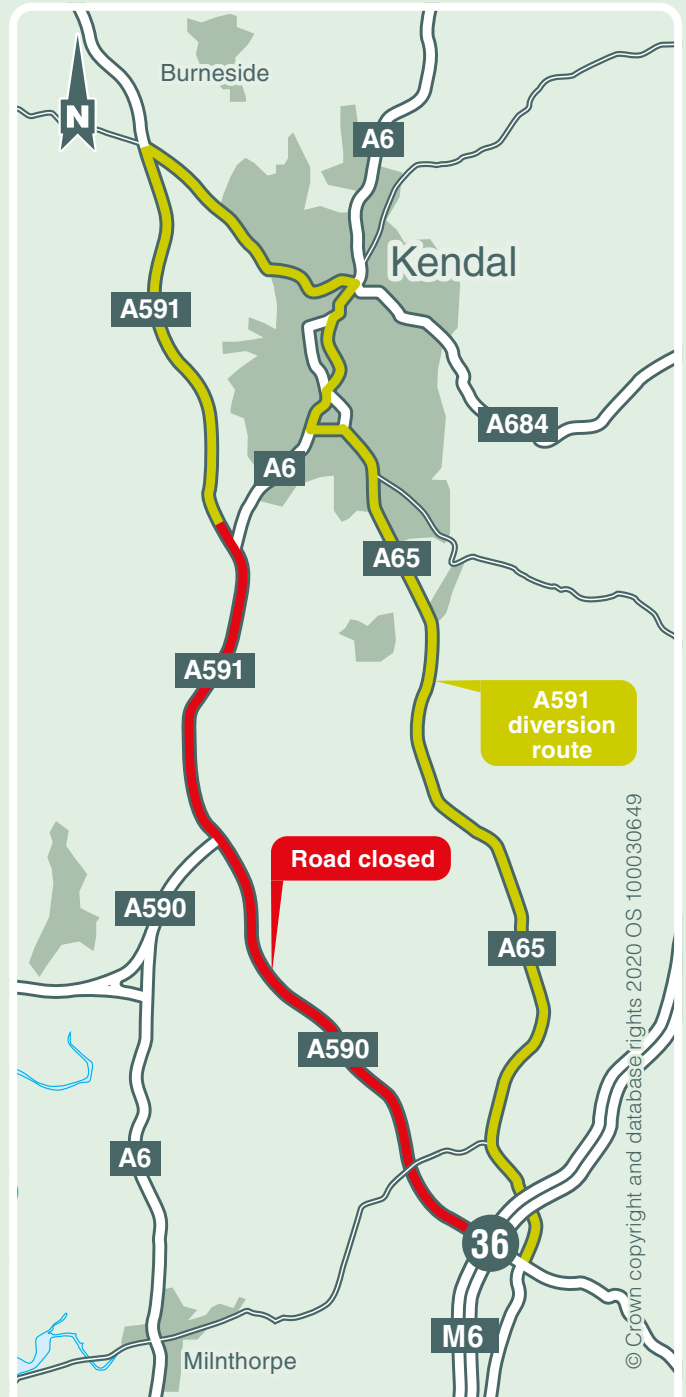
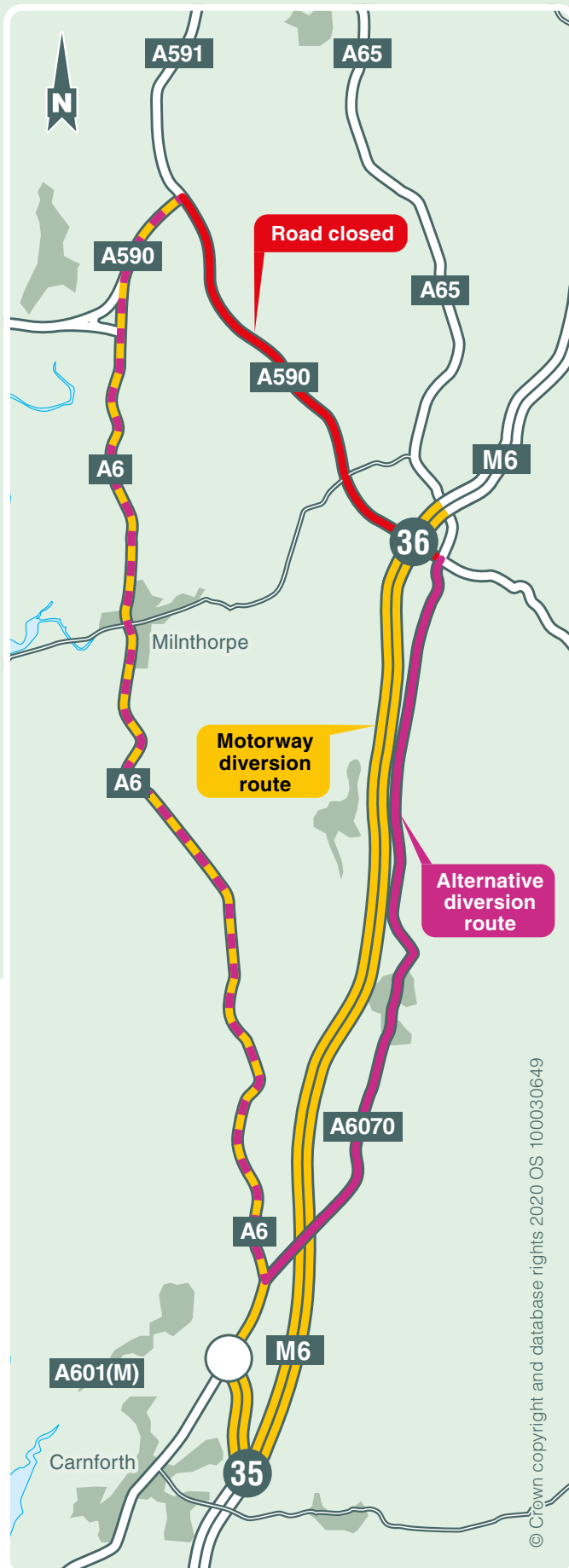

Closure dates

Closure of **Shenstone Interchange**

■ 4 to 6 September

Closure of **A591 southbound** between Shenstone interchange and Brettargh Holt roundabout

■ 11 to 13 September

■ 25 October to 3 November

Events

Due to the coronavirus, we're unable to hold face-to-face public events as we would normally. If you can, please join one of our Microsoft Teams events from Wednesday 26 August to Friday 4 September (weekdays only) at 9am, 10am, 4pm and 6pm each day. Visit our webpage at highwaysengland.co.uk/programme/a590-maintenance-schemes/ for more information on how to join one of these events.

Here we'll give you an overview of the scheme as well as answering any questions you may have regarding our work.

How to stay up-to-date with our free text alert service

To receive live text alerts from Highways England containing timely updates, send a text message from your device with the message **HE-A590-J36** to **0786 005 7529**

Alternatively, you can also contact the team on **0300 123 5000** or email info@highwaysengland.co.uk

*Please note, this data is kept on a secure server and message data is deleted after 6 weeks. Highways England and Kapow, our supplier for this service, do not pass on your information to third parties. The terms and conditions of this service are available on Kapow's website or by emailing info@kapow.co.uk



Covid-19

Please be assured that we have strict safeguarding measures on site to prevent the spread of COVID19 and will be closely monitoring the ongoing situation. We will continue to follow all the latest government advice and will adapt our plans to take account of any changes, keeping our workforce and road users safe.

© Crown copyright 2020.

You may re-use this information (not including logos) free of charge in any format or medium, under the terms of the Open Government Licence. To view this licence: visit www.nationalarchives.gov.uk/doc/open-government-licence/ write to the Information Policy Team, The National Archives, Kew, London TW9 4DU, or email psi@nationalarchives.gsi.gov.uk.

Mapping (where present): © Crown copyright and database rights 2019 OS 100030649. You are permitted to use this data solely to enable you to respond to, or interact with, the organisation that provided you with the data. You are not permitted to copy, sub-licence, distribute or sell any of this data to third parties in any form.

This document is also available on our website at www.highwaysengland.co.uk For an accessible version of this publication please call **0300 123 5000** and we will help you.

If you have any enquiries about this publication email info@highwaysengland.co.uk or call **0300 123 5000**. Please quote the Highways England publications code **PR106/20**.

Highways England creative job number MCR20_0139

*Calls to 03 numbers cost no more than a national rate call to an 01 or 02 number and must count towards any inclusive minutes in the same way as 01 and 02 calls. These rules apply to calls from any type of line including mobile, BT, other fixed line or payphone. Calls may be recorded or monitored.

Printed on paper from well-managed forests and other controlled sources when issued directly by Highways England.

Registered office Bridge House, 1 Walnut Tree Close, Guildford GU1 4LZ
Highways England Company Limited registered in England and Wales number 09346363